

Enterprise Budget Series

Installation Instructions

The “DO IT YOURSELF” pneumatic tube system is simple and economical to install and operate. Using our zip kit terminals on each end of the system, connected by PVC piping and bends; you have a complete working tube system at your service!

Tubing Preparation and Installation

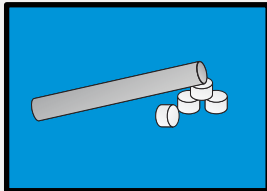

- Use cleaner and glue on pipe and connect with couplings.
- Hang pipe as required and connect to bends with couplings.
- Connect bends to terminals with pipe and couplings.

Recommendation

Use repair couplings instead of regular couplings so pipe can fit end to end.

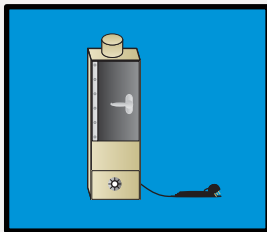

Each terminal has a 6' power cord with plug
(Power requirements - 120 Volts AC 10 amps).

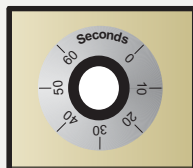

The terminal is equipped with an adjustable timer/pushbutton.
Set the time for 4 seconds longer than it takes to send an empty carrier and for future wear of seal rings on carriers.